

ENTRANCE LOBBY = R+S	
R = 3.0 X 3.75	=11.25 SQ. M.
S = 2.5 X 4.0	=10 SQ. M.
	=
21.25SQ.M.	
CONTROL ROOM = 6.06X4.15	
	= 25.15
SQ.M.	
CHANGE ROOM	
	=
2.92X4.12	
	= 12.03
SQ.M.	
WEIGHING ROOM	
= 2.88 X 3.97	
	= 11.43 SQ.M.
INCHARGE ROOM	
	= 5.88X4.12
	= 24.22 SQ.M.
ELECTRICAL ROOM	
	= 2.88X3.97
	=11.43 SQ.M.
WIF +WIC	
= K+L+M+N	
K = 17.77X4.08	= 72.50
L = 5.85 X 4.08	= 23.86
M = 6.22 X 7.95	= 49.44
N = 5.88X8.13	= 47.80
K+L+M+N=	191.50 SQ. M.
PACKING AREA 1	
	= 20.70X3.75
	= 77.62 SQ.M.
PACKING AREA 2	
	= 5.88X7.07
	= 41.57 SQ.M.
DRY STORAGE II	
	= 5.88X14.60
	= 85.84
SQ.M.	
NOTES	
1. This drawing is copyright.	
2. This drawing should not be reproduced or handed over to third party without consent of competent authority.	
3. Do not scale from this drawing.	
4. All dimensions are in millimetres unless noted otherwise.	
5. These drawings are only indicative and not to be used for construction on site.	
6. Do not make any structural changes on site. The same are not recommended.	

S.NO.	REVISION (READ DOWNWARD)	DATE
1.		
2.		
1.	FOR TENDER	18-01-10
S.NO.	ISSUED TO (READ UPWARD)	DATE

PROJECT
UPGRADATION OF COLD CHAIN FACILITIES IN THE GOVERNMENT MEDICAL STORE DEPOTS AT DELHI KARNAL, HYDERABAD, MUMBAI, CHENNAI KOLKATA & GUWAHATI.

FLOOR PLAN & DETAILS (KOLKATA)	SCALE JAN 2010
TITLE	DATE

OWNER:-

ARCHITECT:-

DWG.NO.: GMSD/KOL/AR/01
DEALT BY:

ARCHITECT :
SURINDER SAWHNEY ASSOCIATES
ARCHITECTS & DESIGN CONSULTANTS
571, SECTOR-18-B, CHANDIGARH
E-MAIL: surindersawhney@sify.com
PH:0172-2780535, FAX : 0172-2726627.

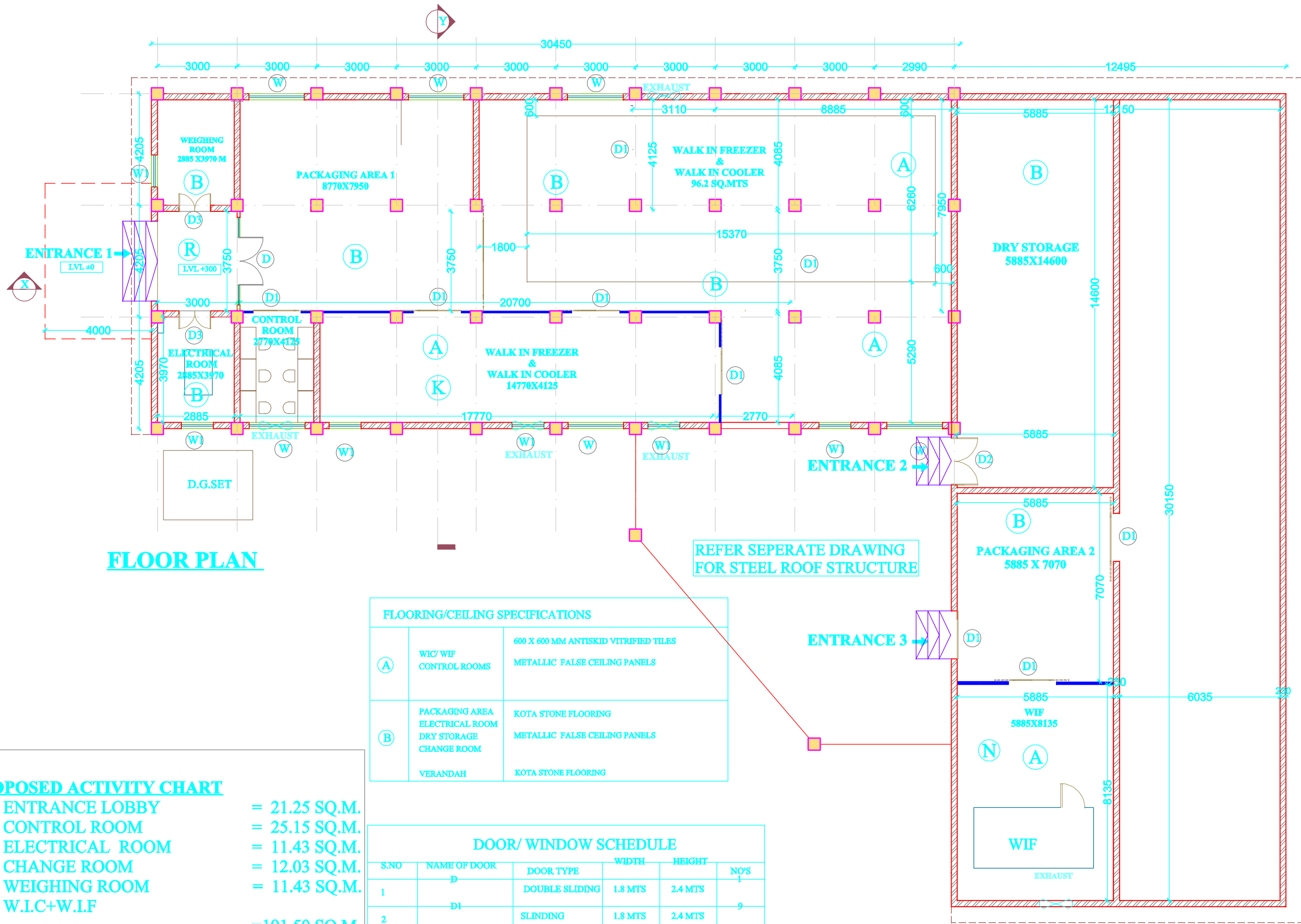

FLOOR PLAN

FLOORING/CEILING SPECIFICATIONS

(A)	WIC/ WIF CONTROL ROOMS	600 X 600 MM ANTISKID VITRIFIED TILES METALLIC FALSE CEILING PANELS
(B)	PACKAGING AREA ELECTRICAL ROOM DRY STORAGE CHANGE ROOM	KOTA STONE FLOORING METALLIC FALSE CEILING PANELS
	VERANDAH	KOTA STONE FLOORING

DOOR/ WINDOW SCHEDULE

S.NO	NAME OF DOOR	DOOR TYPE	WIDTH	HEIGHT	NO'S
1	D	DOUBLE SLIDING	1.8 MTS	2.4 MTS	1
2	D1	SLINDING	1.8 MTS	2.4 MTS	9
3	D2	DOUBLE HINGED	1.8 MTS	2.1MTS	1
4	D3	HINGED	1.2 MTS	2.1 MTS	3
5	D4	HINGED	1.0 MTS	2.1 MTS	2
6	D5	SLINDING	1.2 MTS	2.1 MTS	

PROPOSED ACTIVITY CHART

- ENTRANCE LOBBY = 21.25 SQ.M.
- CONTROL ROOM = 25.15 SQ.M.
- ELECTRICAL ROOM = 11.43 SQ.M.
- CHANGE ROOM = 12.03 SQ.M.
- WEIGHING ROOM = 11.43 SQ.M.
- W.I.C+W.I.F = 191.50 SQ.M.
- PACKING AREA 1 = 77.62 SQ.M.
- PACKING AREA 2 = 41.57 SQ.M.
- DRY STORAGE II = 85.84 SQ.M.
- INCHARGE ROOM = 24.22 SQ.M.

TOTAL AREA = 502.04 SQ.M.